

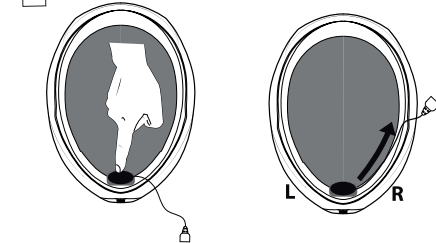

5 POSTAVI MIKROFON

Opcija 2

Montaža na Full face kacige

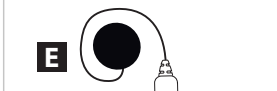
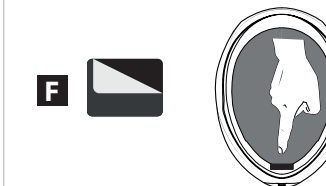
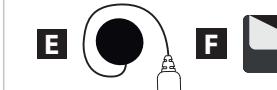
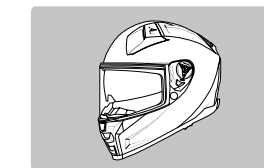

6 UMETNITE CENTRALNU JEDINICU

6.a

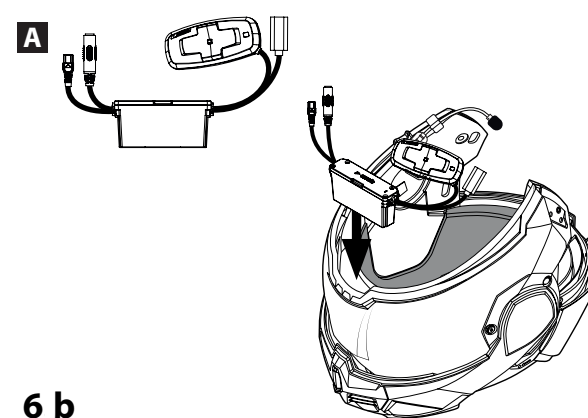

6.b

Ubacite u predviđeno mesto

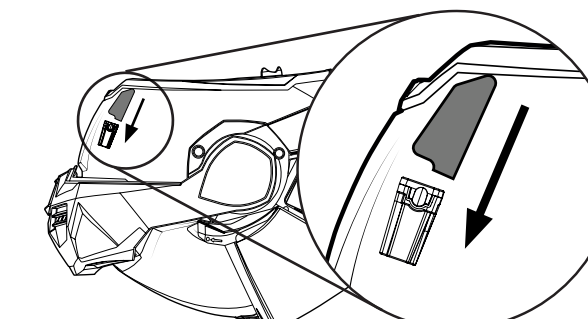

7 SPOJITE ŽICE

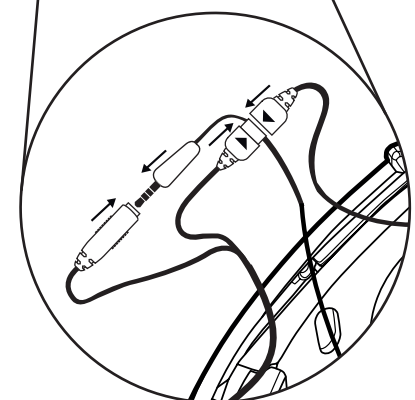
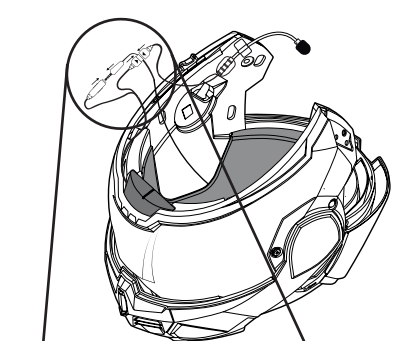

8 POSTAVITE SPOLJNU JEDINICU

Opcija 1

8.a

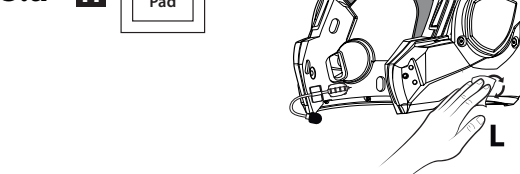

8.b

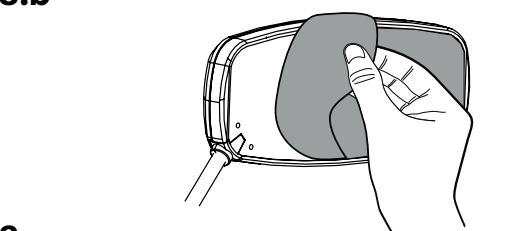

8.c

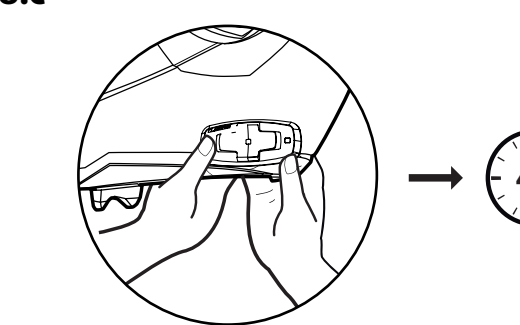

Opcija 2

8.a

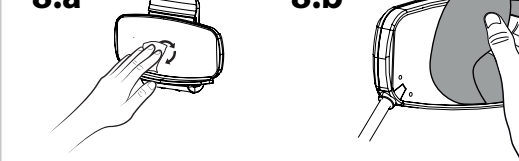

8.b

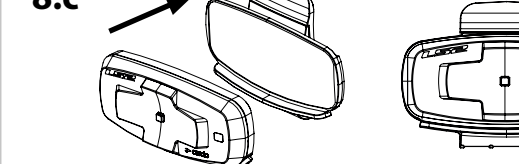

8.c

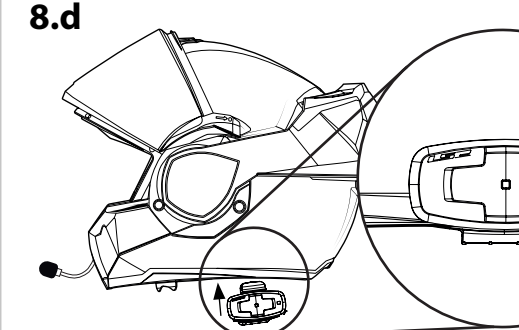

9 POSTAVITE ŽICE

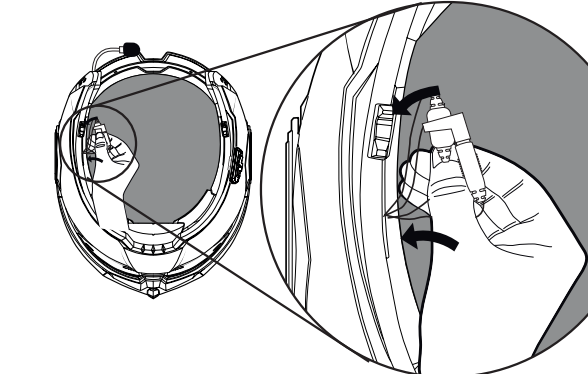

10 VRATITE POSTAVU

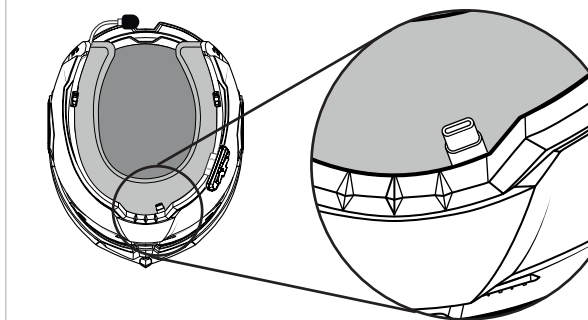
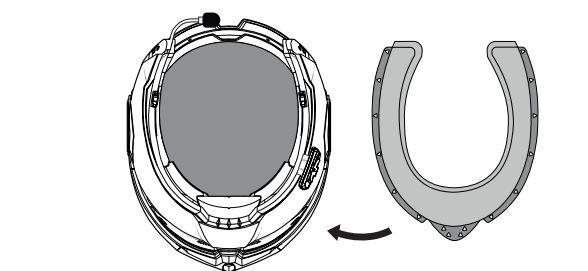

Ostavite USB priključak za punjenje dostupnim

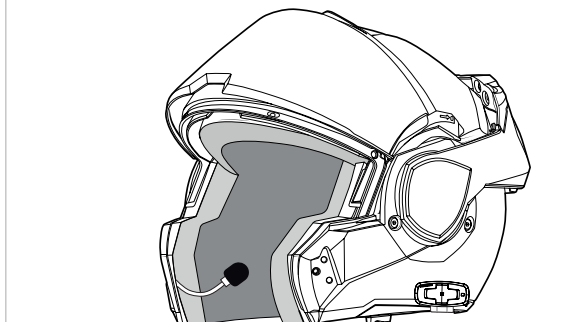

11 PODIZAČI

Opciono



Ako je potrebno, koristite podizače da biste postavili zvučnike bliže uhu

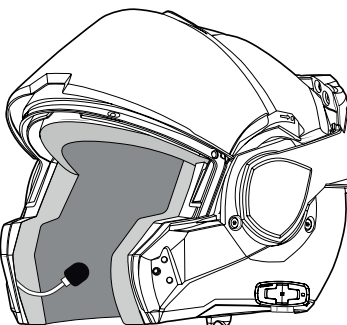
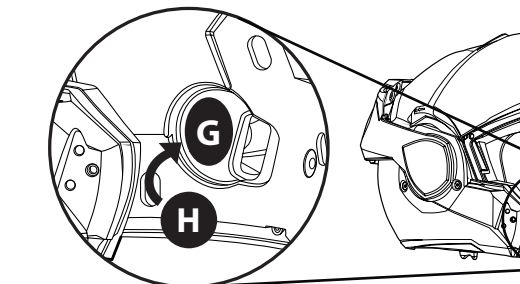
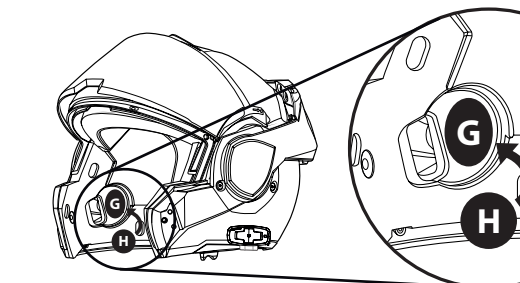

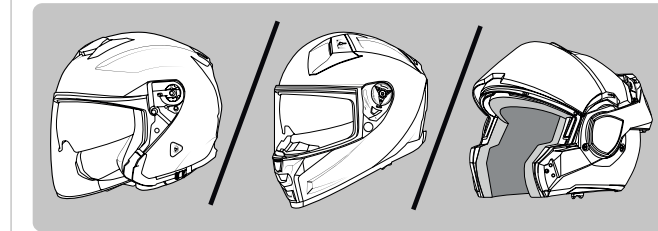

Da biste instalirali na drugu kacigu osim ADVANT FF906, skenirajte QR kod.

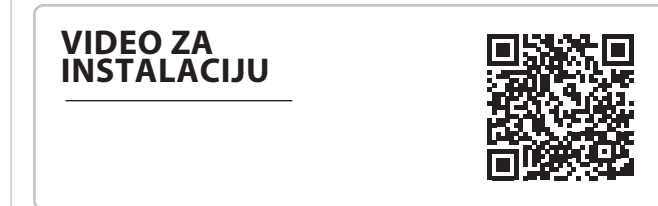

1 **PODIGNITE VIZIR**

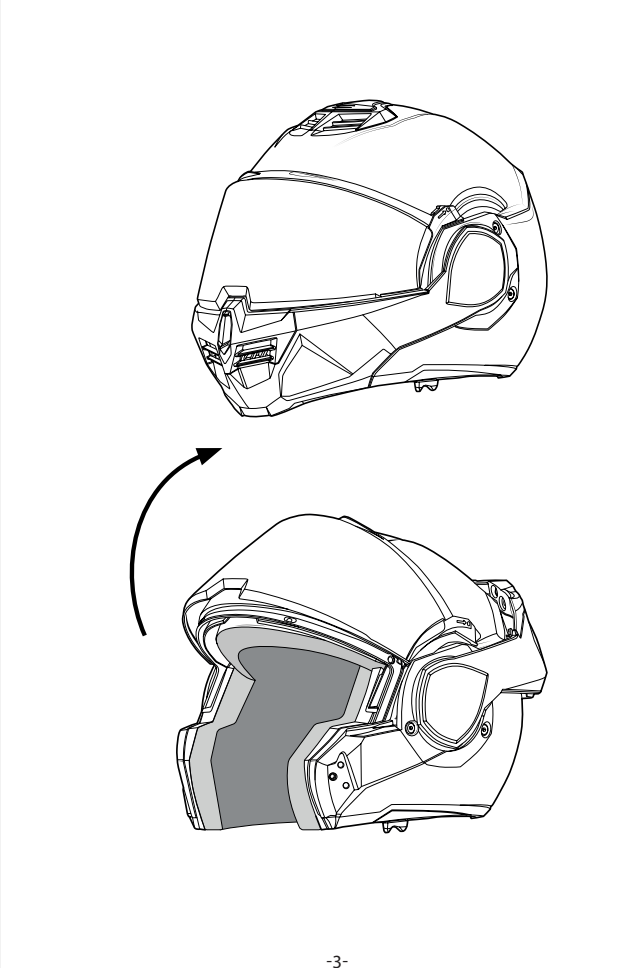

2 **UKLONITE POSTAVU**

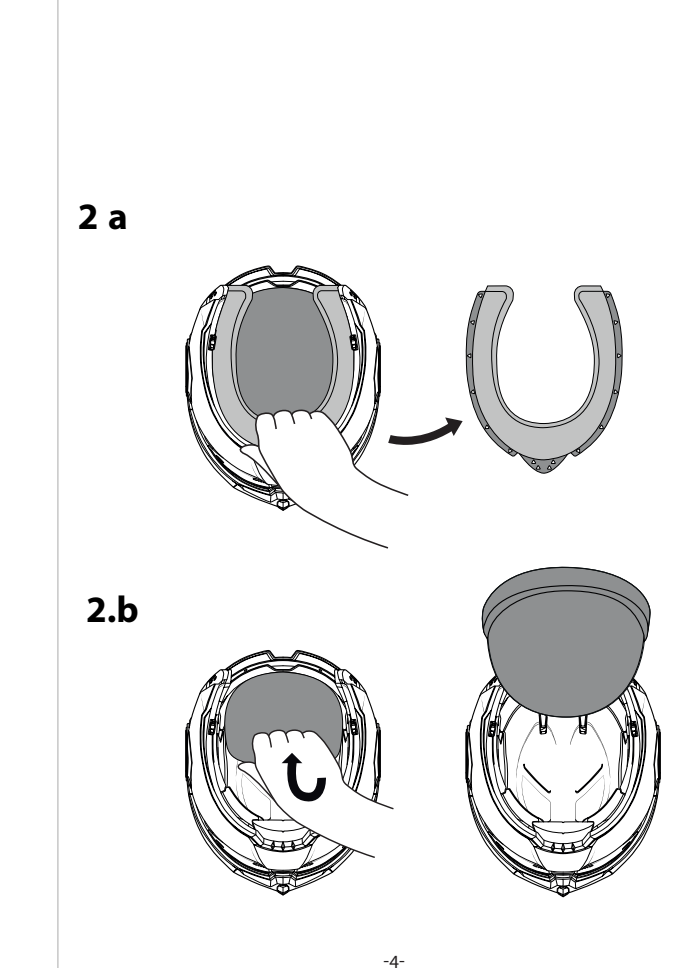

3

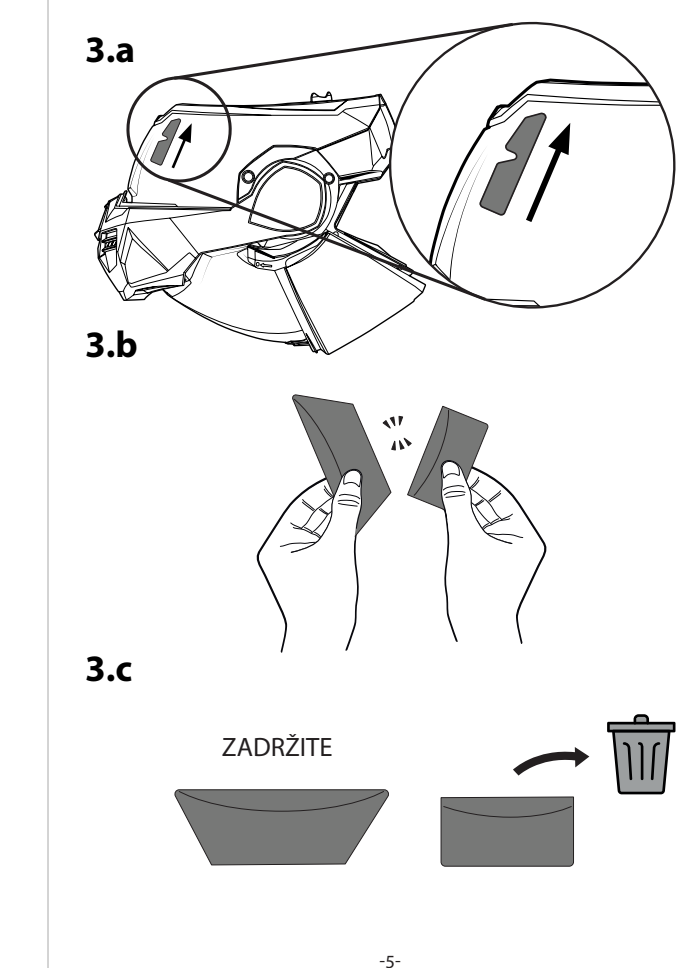

4 **POSTAVITE ZVUČNIKE**

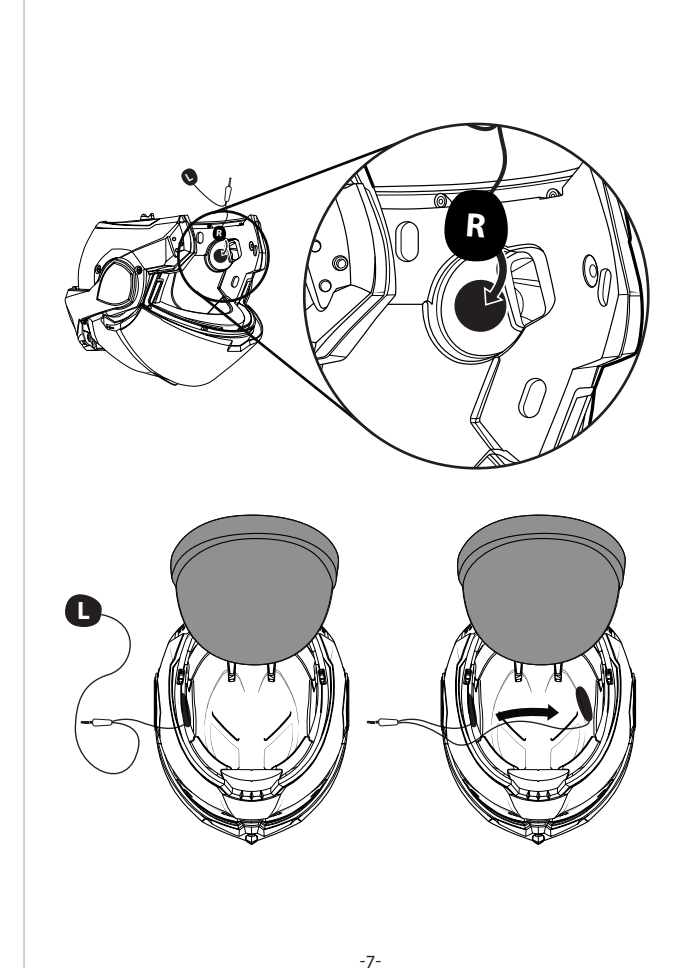
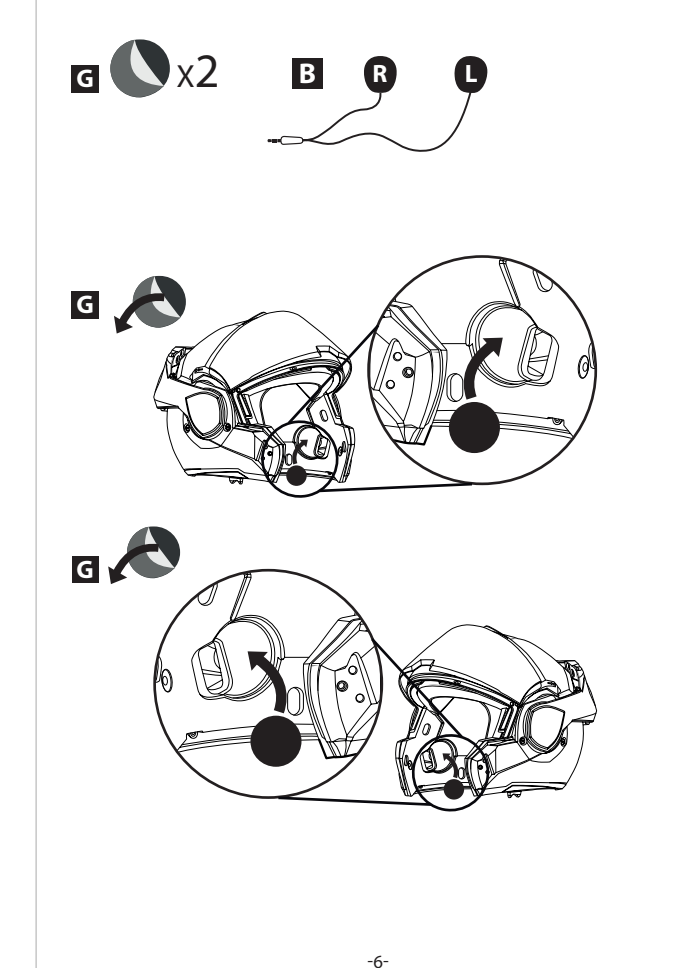

5 **POSTAVITE MIKROFON**

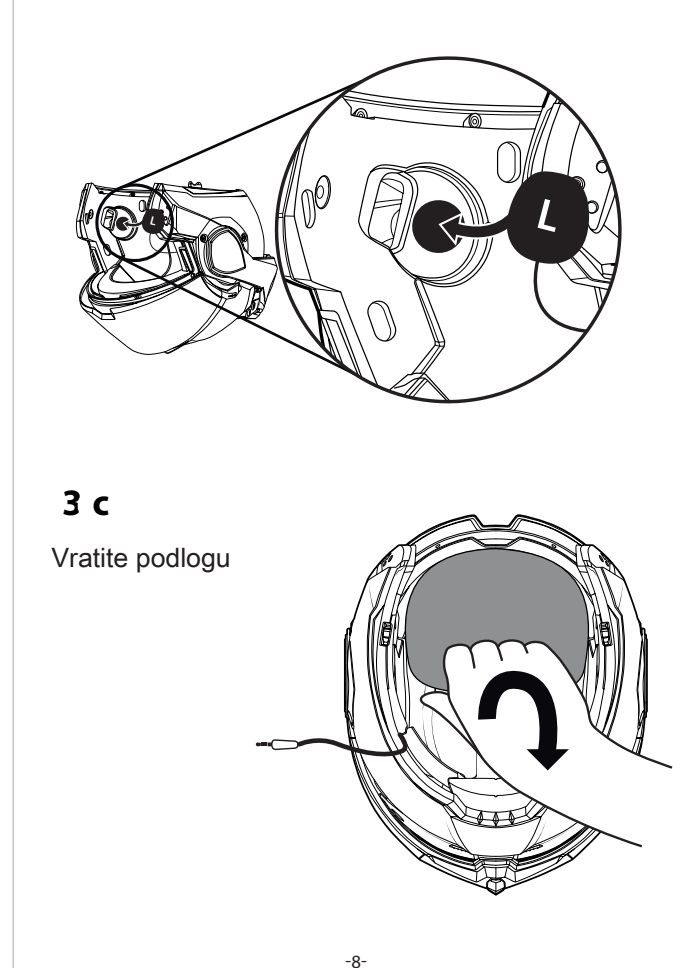

5.b

